

SBI Ltd
Call 0800 0742 721
www.sbiproducts.co.uk



Contemporary Alfresco

Technical Information

The Contemporary Alfresco is perfect for creating a dry, and sheltered area within your garden, enabling you to enjoy the outdoors all year round. You can host garden parties, BBQ's or simply spend time with your family outside without worrying about the weather.



Size:

Projection: Up to 6m
Length: Unlimited
Post Spacing: 6m Maximum

Materials:

Main Frame: Aluminium
Roof Bars: Aluminium
Posts: Aluminium
Guttering: Aluminium
Roof Sheets: Choice of 8mm Toughened Glass or 35mm Structured Polycarbonate (Opal, Clear and Bronze). (Tinted and self cleaning glass are not available with Alfresco systems).

Colour Options:

The main frame, roof bars, guttering and posts are supplied in White (Semi-Gloss) (RAL 9016) as standard. They can be powder coated to any RAL colour to suit your needs.

Contemporary Alfresco

Features & Benefits

Smooth and Sleek Design:

To fit in perfectly with modern homes and new build.

Choice of Roof Panels:

Choose from 8mm toughened glass or 35mm structured polycarbonate roof panels. Clear, Opal and Bronze polycarbonate available.

Toughened Glass:

The 8mm glass panels are toughened during manufacturing and achieve Class 1 BS EN 12600 for impact performance.

Polycarbonate:

The 35mm structured polycarbonate is vandal and shatter resistant.

High Light Transmittance:

All roof options offer high light transmittance.

Integral Aluminium Guttering and Easy-Fix Profiles:

Creates a sleek, modern design which is stronger than external guttering and also means all cabling is hidden from view.

Low Maintenance:

All roof options are low maintenance, particularly the glass, which means less cleaning, saving you time and money.

Additional Upgrades:

You can enhance the use of your Canopy by adding heating, lighting and even sound, permitting for all year-round use. The LED lighting option provides a soothing glow allowing for use of the system in the darker hours of the day. With a choice of Infrared or Relax heaters, you will never be cold under the system again. Enhance the ambiance with our Relax Sound Outdoor Speakers, with easy connect through Bluetooth anyone can be the DJ.

Full 10 Year Guarantee:

The Contemporary Alfresco is supplied with a full 10 year guarantee and a 25 year life.



Contemporary Alfresco

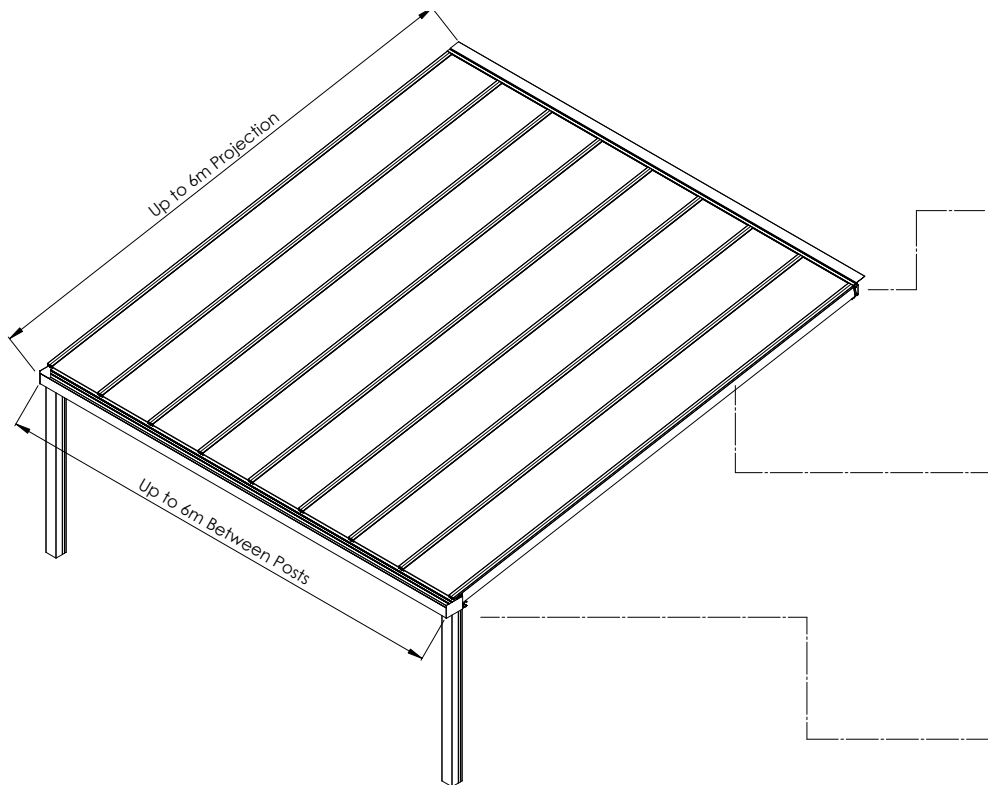

Wall Plate & Roof Glazing Bolster Bar Section

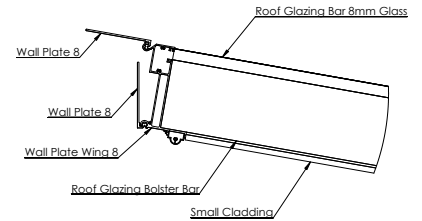

Roof Glazing Bar & Sheet Section

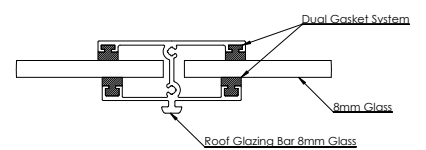

Eaves Beam, Roof Glazing Bolster Bar & Post Section

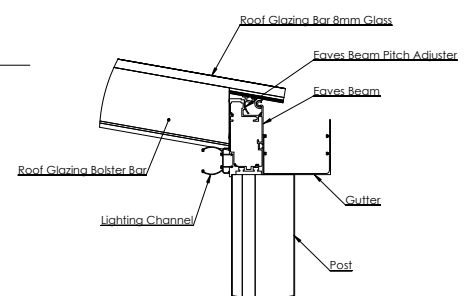

Base & Post Connection Information

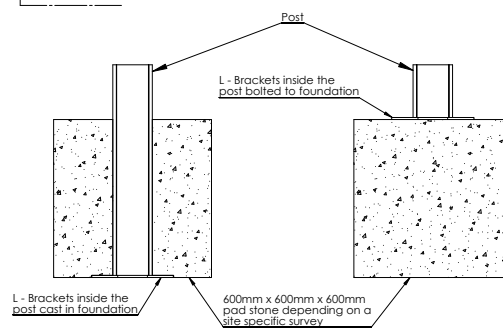

Material List & Component Information :

- 1, The canopy wall plate is an extruded aluminium profile which fixes to the wall or steel bracket.
- 2, This canopy uses 8mm glass roof panels in clear.
- 3, This canopy uses our gasketed 8mm glass roof system, which is constructed from T6 grade structural aluminium frame.
- 4, The frame of the canopy is made from 150mm x 150mm x 2.5mm aluminium box section.

The frame is available, Powder coated.

Please note: This is a standardised product data sheet and is subject to change depending on individual cases, or site specific surveys. Specific drawings are available upon request or on receipt of an order.

Contemporary Alfresco

Upgrades

Glass Room upgrade

The Alfresco Glass Room range features a selection of stunning wall mounted structures that have an impressive 6m projection with a 6m span between posts. This is extremely versatile and can be used for many applications such as alfresco dining areas, swimming pool canopies and socialising areas for parties and gatherings, not to mention quiet, tranquil areas to relax. This range is one of the best outdoor glass rooms available on the market due to the specially engineered design, robust construction materials, high class appearance and 10-year guarantee.



Lighting and Heating:

The lighting on the Alfresco system is hidden within the frame for a sleek, streamline appearance. To further improve the aesthetics and more importantly the safety, the wires have been hidden. By adding heating and lighting to your system you are now able to spend more time outside in the evenings enjoying the company of your friends and family or even to relax alone.



SBI Ltd
Call 0800 0742 721
www.sbiproducts.co.uk